

AC2256

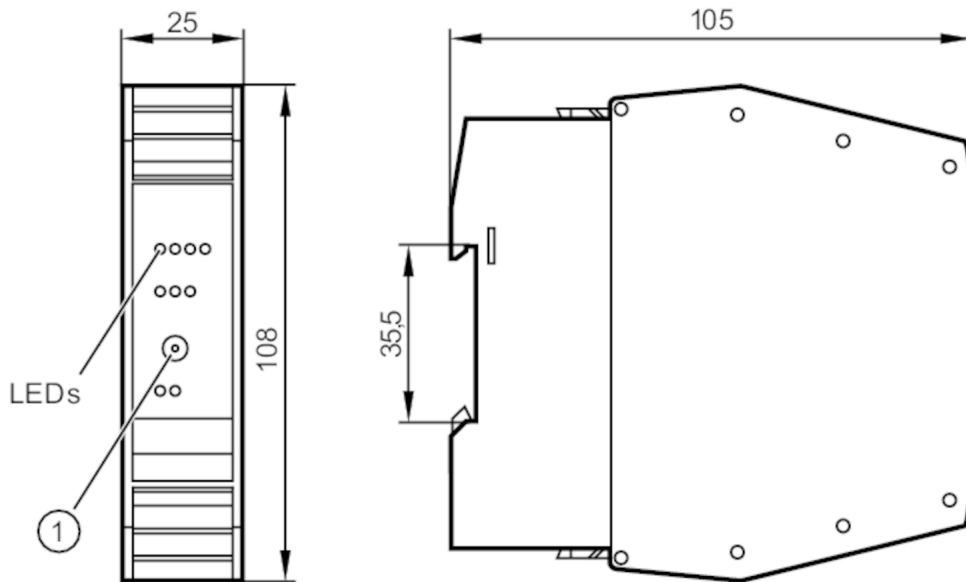

AS-Interface control cabinet module

SmartL25 4DI 2DO R C



1 Addressing socket



Application

Application I/O modules for control cabinet installations

Electrical data

Operating voltage [V]	26.5...31.6 DC
Max. current consumption from AS-i [mA]	250
Integrated watchdog	yes

Inputs / outputs

Number of inputs and outputs Number of digital inputs: 4; Number of relay outputs: 2

Inputs

Number of digital inputs	4
Input circuit of digital inputs	PNP; (type 2 according to IEC 61131-2)
Sensor supply of the inputs	AS-i
Voltage supply [V]	18...30; (DC)
Max. total current rating of inputs [mA]	200
Input current High [mA]	6...10
Input current low [mA]	0...2
Min. switching level high signal [V]	11
Digital inputs protected against short circuits	yes

AC2256



AS-Interface control cabinet module

SmartL25 4DI 2DO R C

Outputs					
Voltage range DC	[V]	24			
Voltage range AC	[V]	10...240			
Max. current load per output	[mA]	6000; (230 V AC; 24 V DC; resistive load)			
Max. current load outputs total	[A]	6; (230 V AC; 24 V DC; resistive load)			
Number of relay outputs		2			
Short-circuit proof		no			
Electrically separated		yes			
Operating conditions					
Ambient temperature	[°C]	-25...70			
Max. relative air humidity	[%]	90; (non condensing)			
Max. height above sea level	[m]	2000			
Protection		IP 20			
Degree of soiling		2			
Tests / approvals					
EMC		EN 50295			
		EN 50178			
MTTF	[years]	325			
AS-i classification					
AS-i version		2.1; 3.0			
AS-i addressing		Addressing socket			
Extended addressing mode		yes			
AS-i profile		S-7.A.E			
AS-i I/O configuration	[hex]	7			
AS-i ID code	[hex]	A.E			
AS-i certificate pending		yes			
Data bits	Data bit	D0	D1	D2	D3
	Input	I-1	I-2	I-3	I-4
	Output	O-1	O-2	-	-
Mechanical data					
Weight	[g]	195.5			
Type of mounting		Mounting on DIN rail; String mounting possible			
Material		PC-GF20			
Displays / operating elements					
Display	Switching status	LED, yellow I1...I4 O1...O4			
	Power	LED, green AS-i			
	errors	LED, red			
Accessories					
Accessories (optional)		cage clamps			
Remarks					
Pack quantity		1 pcs.			

AC2256



AS-Interface control cabinet module

SmartL25 4DI 2DO R C

Electrical connection

COMBICON:

Connection

I-	I-	I-	I-
I1	I2	I3	I4
I+	I+	I+	I+

14	11	11	12
24	21	21	22
A+	A-		

A+	AS-i +
A-	AS-i -
I+	Sensor supply +24V
I-	Sensor supply 0V
I1...I4	Switching input sensor 1...4